

# SYSTEM LT/ATS-572

Thermally broken system for thin large format panel

## Installation procedure

Assembly of the aluminum frame for the cladding panel. If it is necessary to increase the bearing capacity of the frame, it is possible to install additional vertical or horizontal stiffeners made of aluminum profiles of a suitable section.

Gluing the panel into an aluminum frame should comply with all the recommendations of the adhesive manufacturer. The adhesive should be applied in such a way that after hardening between the panel and each profile, a single strip of the adhesive layer is formed without breaks along the length and width of this strip.

Safety clamps ND-153 are installed on the bottom and side ends of the assembled panel and fixed to the frame profiles with rivets A2 / A2  $\varnothing$ 3-4.

# FEATURED ATTACHMENT BLOCKS



## ATS BLOCK

Backup Wall

- CMU
- Concrete
- Brick



## ATS HIGH BLOCK

Backup Wall

- Concrete slab



## LT BLOCK

Backup Wall

- Steel/Wood studs
- CMU
- Concrete
- Brick

# FEATURED ASSEMBLIES

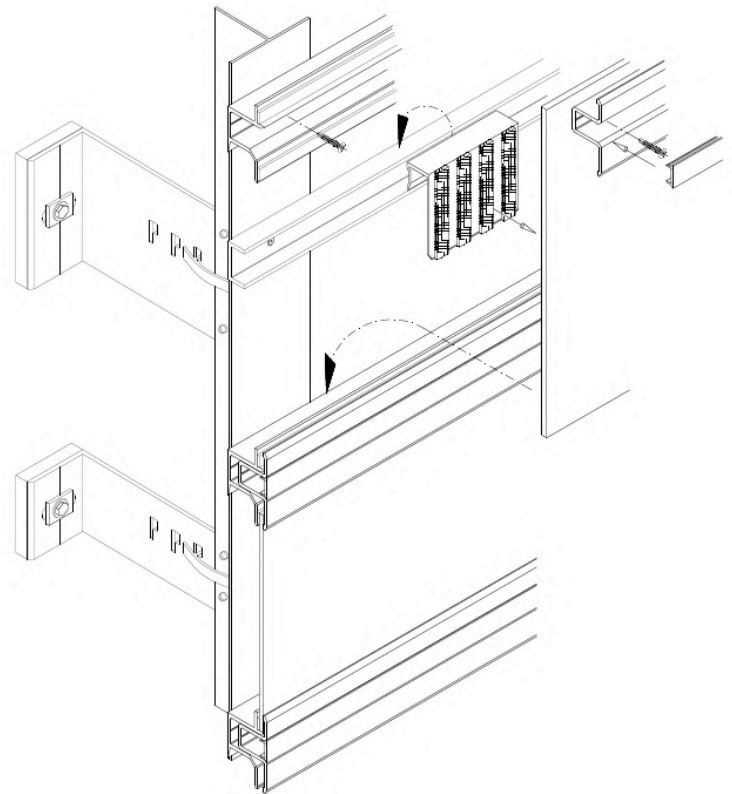
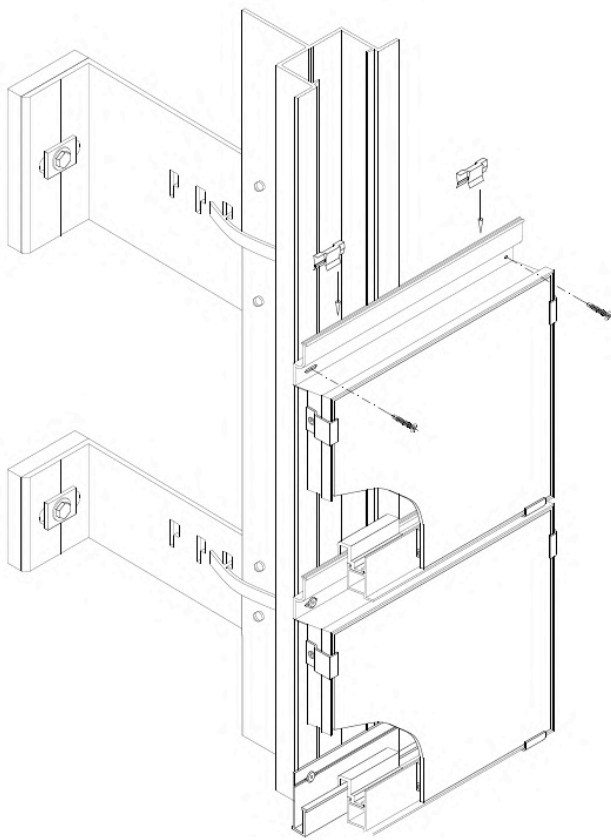

# DETAILS

