

SYSTEM LT/ATS-147P

Thermally broken system for flat panels (HPL, FIBERCEMENT, ACM)

Installation procedure

The installation process for flat panels depends on the type of the panel.

Most of the flat panels are required predrilled holes in different diameters to allow panel to expand and contract without damaging the panel.

U-kon Systems has developed large variety of vertical profiles that can meet all manufacturer requirements such as: TRESPA, FUNDERMAX, EQUITONE, SWISSPEARL, CEMBRIT, PODEMA, ABET etc.

FEATURED ATTACHMENT BLOCKS



ATS BLOCK

Backup Wall

- CMU
- Concrete
- Brick



ATS HIGH BLOCK

Backup Wall

- Concrete slab



LT BLOCK

Backup Wall

- Steel/Wood studs
- CMU
- Concrete
- Brick

FEATURED

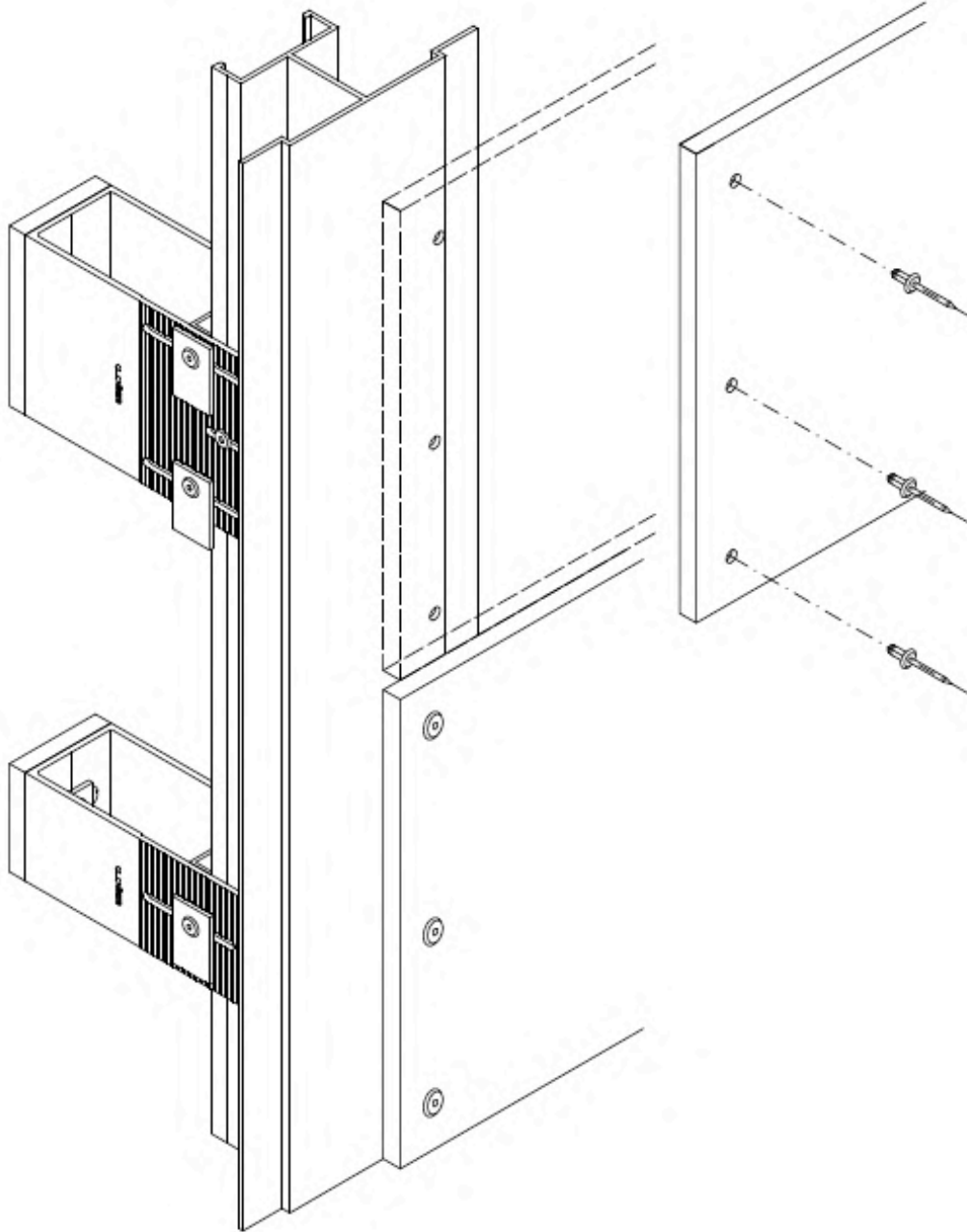

DETAILS

