

# SYSTEM LT/ATS-228

Thermally broken system for concealed fastening

## Installation procedure

Installation of hangers on cladding panels using facade undercut anchors.

Installation of the horizontal profile on vertical girts, fastening with rivets A/A2  $\varnothing 5$  (one rivet is installed in a round hole, all the rest in oval holes).

Installation the bottom row of cladding panels. Alignment of cladding panel using adjusting screws on the hangers.

Fixing cladding panels using aluminum or steel fastener, installed in one of the hanger of each cladding panel. Installation of subsequent rows of cladding panels.

# FEATURED ATTACHMENT BLOCKS



## ATS BLOCK

Backup Wall

- CMU
- Concrete
- Brick



## ATS HIGH BLOCK

Backup Wall

- Concrete slab



## LT BLOCK

Backup Wall

- Steel/Wood studs
- CMU
- Concrete
- Brick

# FEATURED ASSEMBLIES

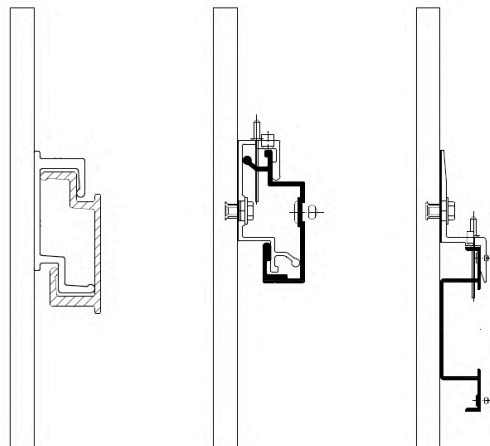
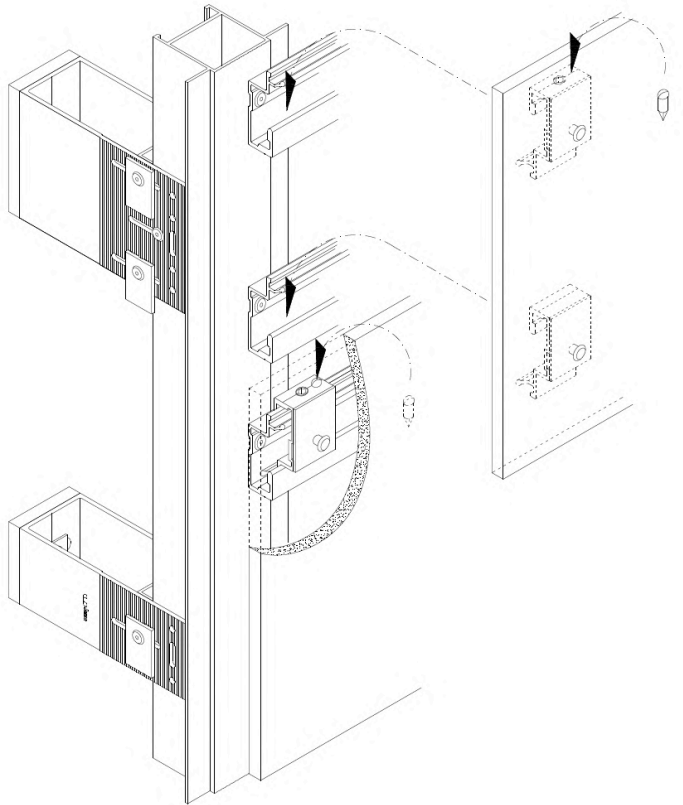

# DETAILS

